

**Politecnico di Milano**  
**Scuola di Architettura e Società**  
**Dipartimento di Architettura e Studi Urbani**

**Thematic Studio “Edgelands and Urban Agriculture”**  
**Corinna Morandi, Fabrizio Leoni, Andrea Rolando,**

**Tutors:**  
**Matteo Paracchini, Paola Sturla**



Urban Design studio

# Edgelands and urban Agriculture



**Berlin, April 29th – May 3rd, 2013**  
**ANCB AEDES NETWORK CAMPUS\_Berlin**

# Learning from Berlin

**1** studio

Edgelands and Urban Agriculture

**27** students

**12** nationalities

The emerging of the themes of **edgelands** and **urban agriculture**, focused on a new consideration of the role of the spaces **in-between the urban and the rural**, and on the relationships city/agriculture or **production/consumption/leisure**, draws the attention of planners, urban and landscape designers towards a specific interest in those open spaces, which play economic, **spatial, ecological and social roles**.

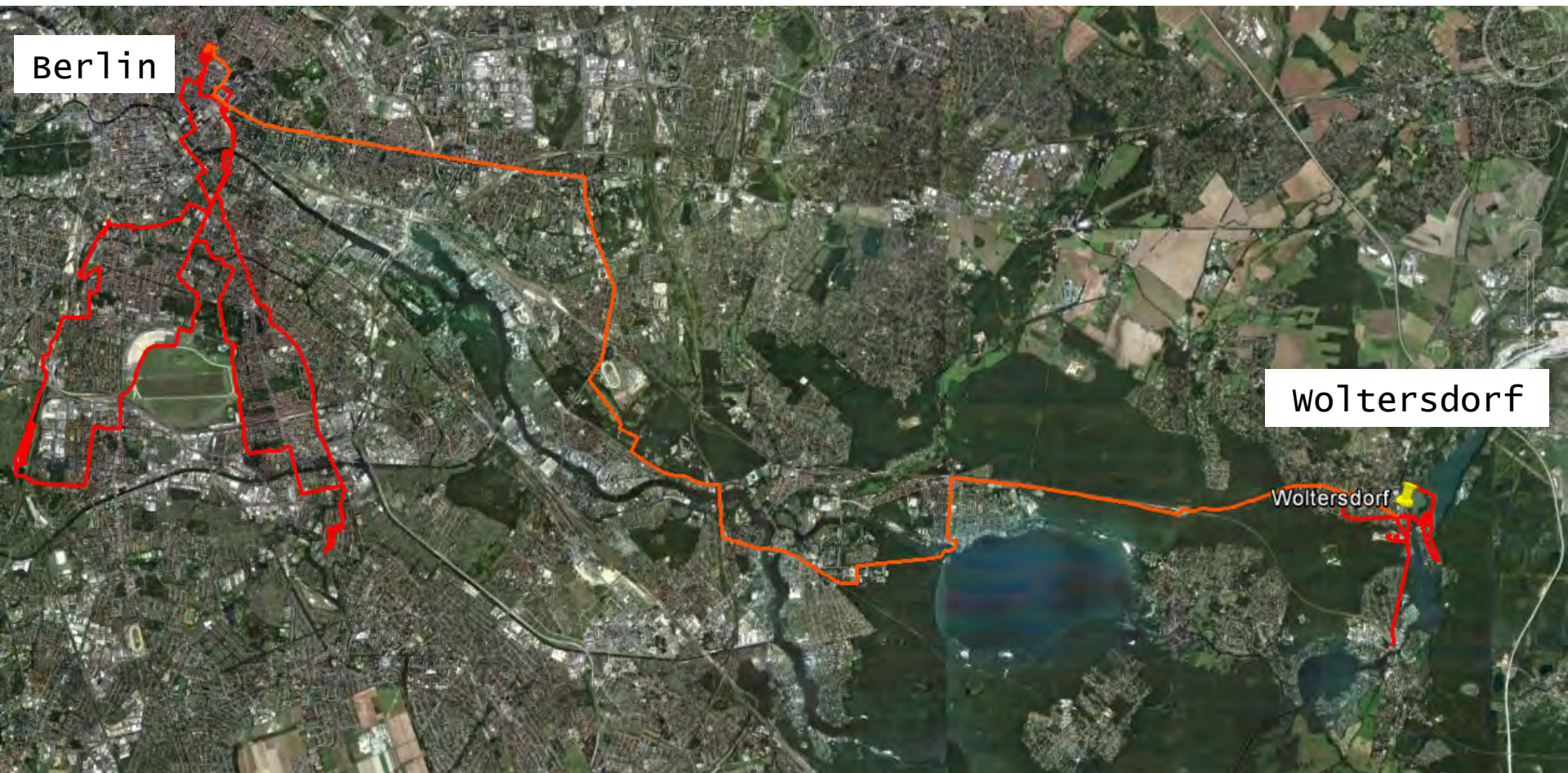

Berlin

Woltersdorf

Woltersdorf

Experiencing urban and territorial scale

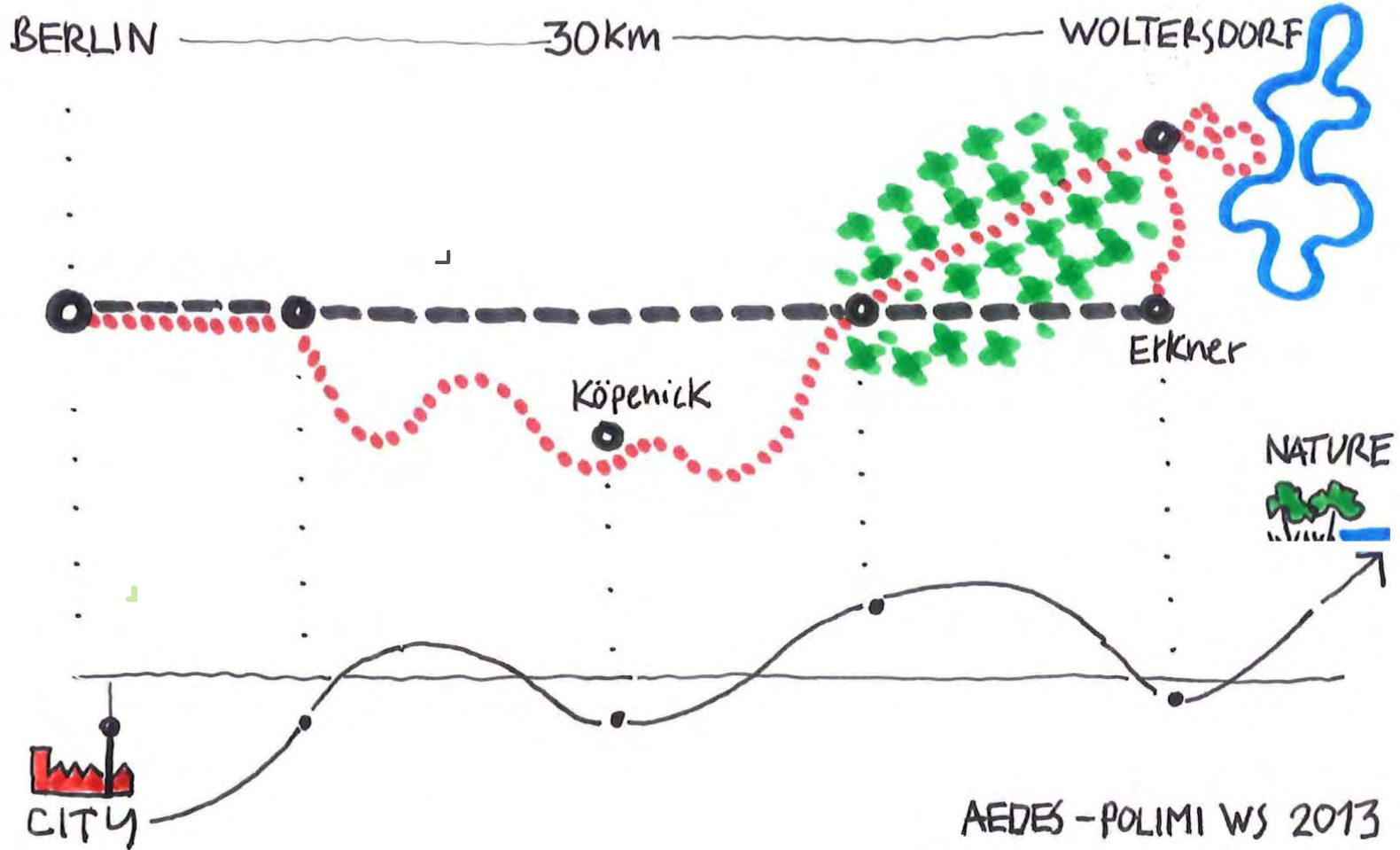

Experiencing urban and territorial scale:  
 Carl Marx Allee, Köpenick, Rahnsdorf, the forest, Woltersdorf



A similar situation in Milan



Interacting with nature





Productive Landscape







material total

PAPYRUS.COM

B

B

# woltersdorf





woltersdorf, the town center



Corbetta, the town center



Erkner, the railway station



Corbetta, the railway station



From Woltersdorf to Rahnsdorf through the forest along the tramway





From Corbetta to Milano through the countryside along a canal



woltersdorf

# working in woltersdorf

- **Experiencing** the territorial Relationships **1**
- Reading the **topography** of the site **2**
- **Interacting** with each **tree** **3**
- Thinking about **social life**, **leisure** and **urban agriculture** **4**
- Understanding what **typologies** may be suitable **5**

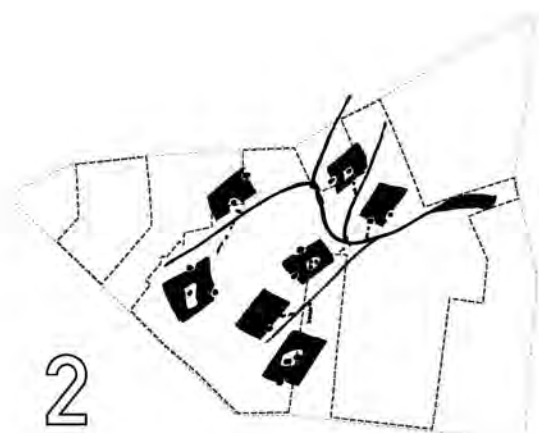

2

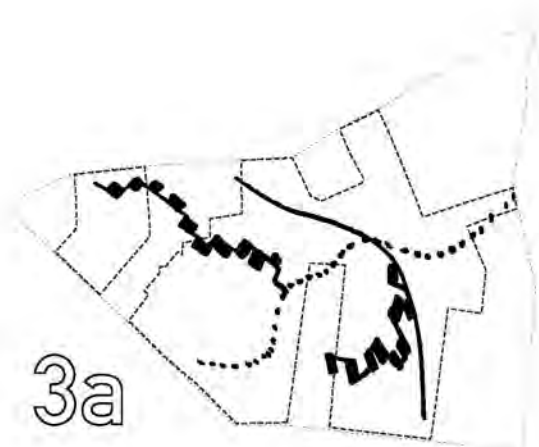

3a

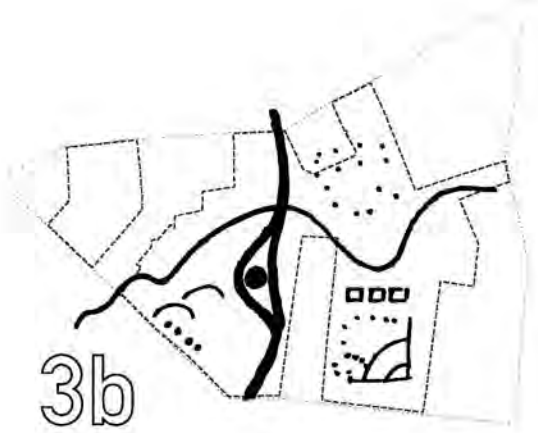

3b

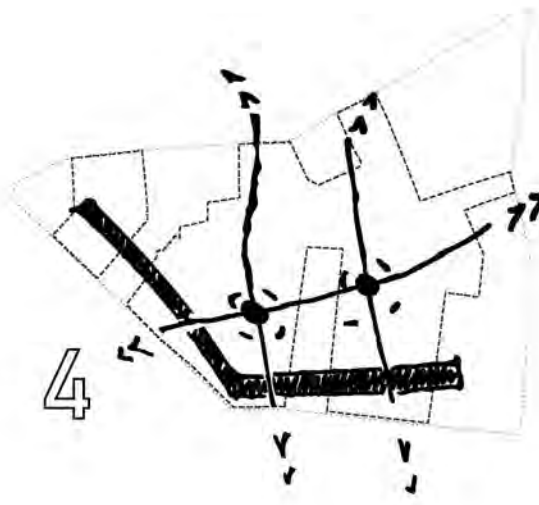

4

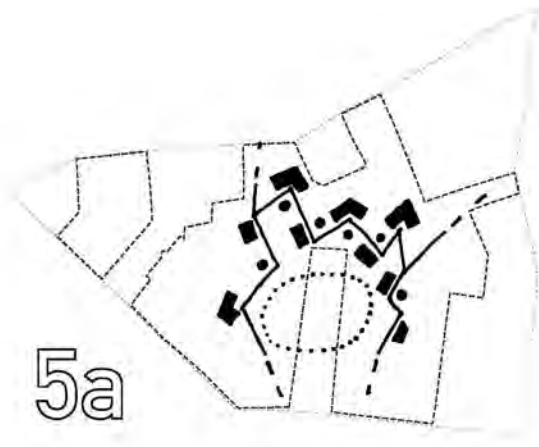

5a

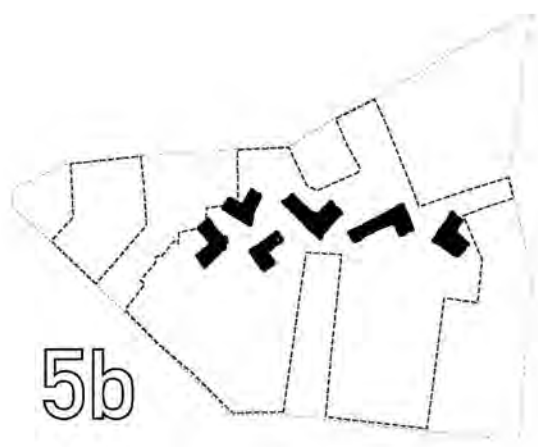

5b



# connections to services

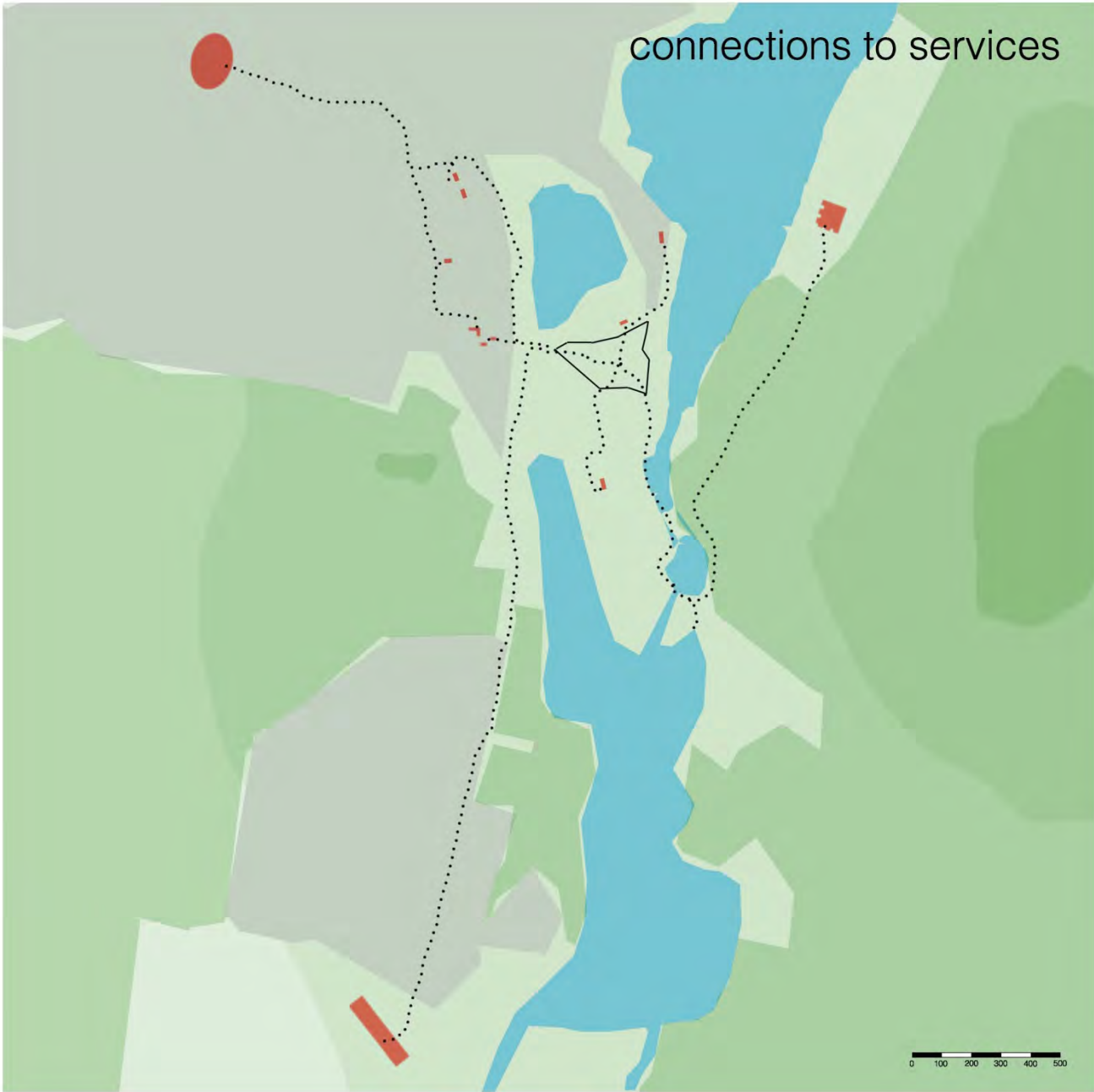

# lake's dwelling

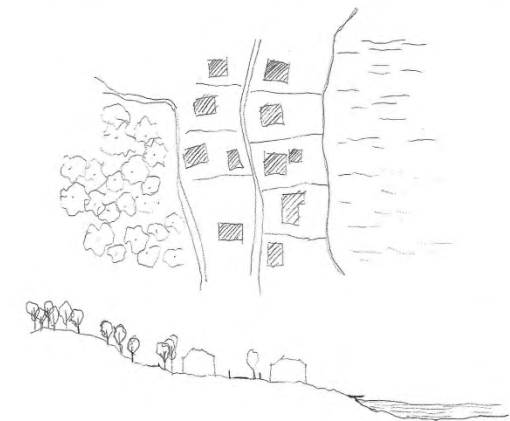

# MASTERPLAN 1

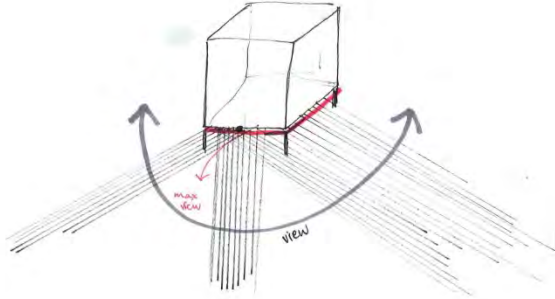
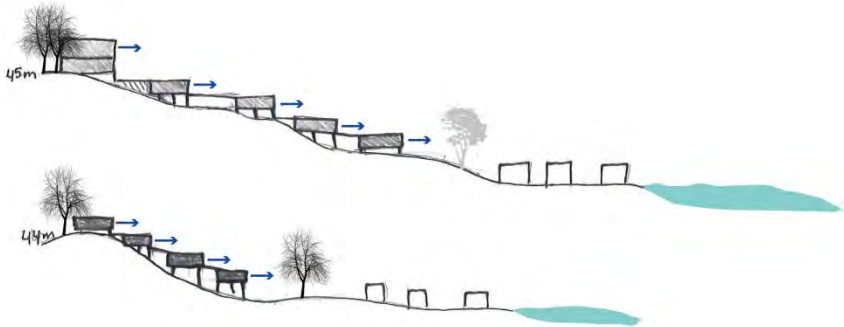
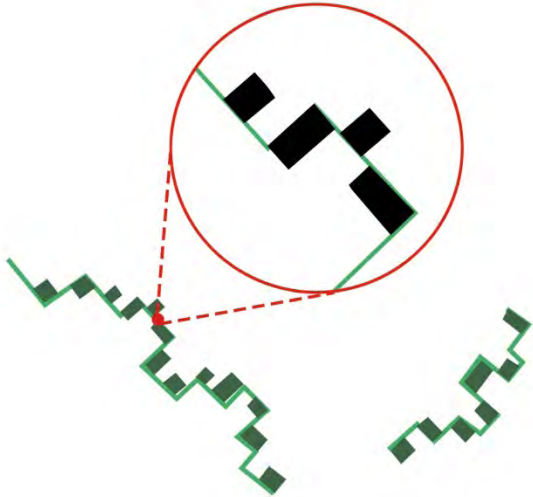

# MASTERPLAN 2

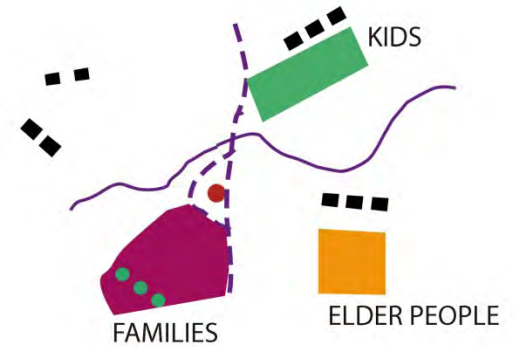

KINDER GARDEN

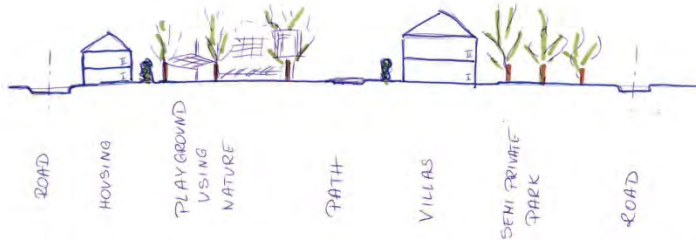

→ HOSPITAL

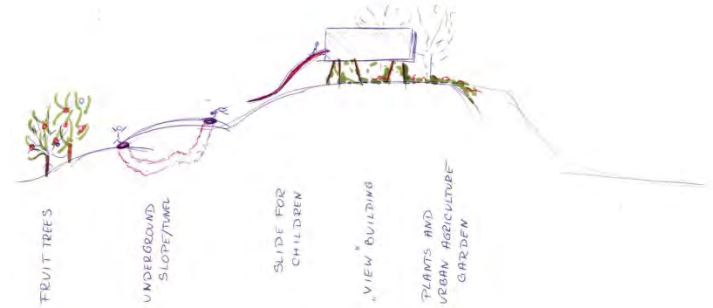

Interactive  
palces



KEY PLAN





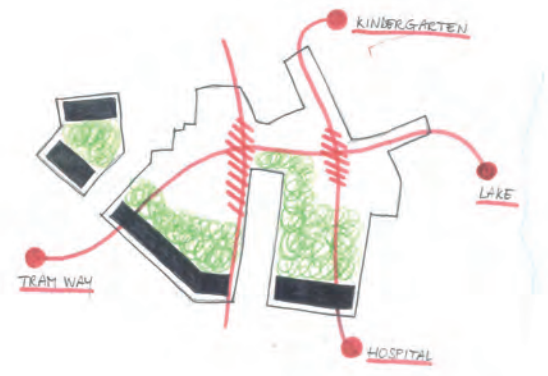
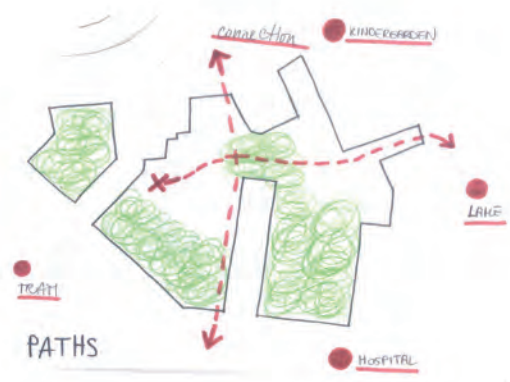
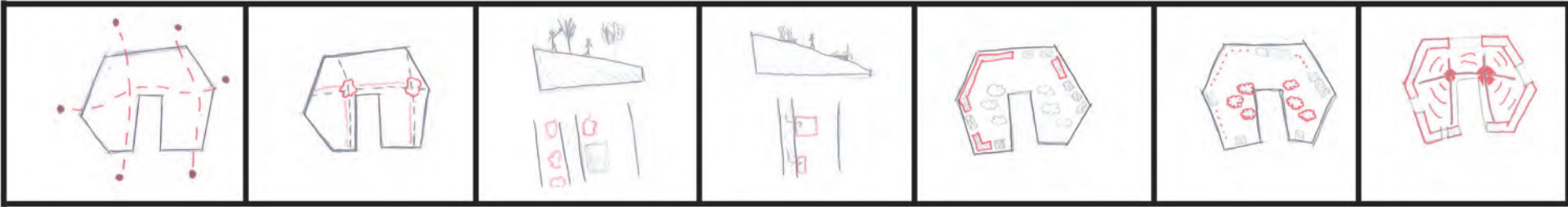



from  
LOW DENSITY

1st year

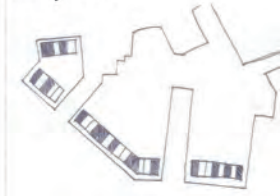

5th year



10th year



to  
HIGH DENSITY



MASTERPLAN

# Master Plan (Low Density)



sezione A-A'

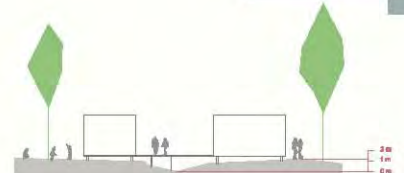

sezione B-B'



sezione C-C'

## Pre-existing



## Define Path



## Built elements



## Use and connection with the City



### MINIMUM SQ\_one floor building

280 sq	16 people
570 sq	24 people
<b>TOT 850 sq</b>	<b>40 people</b>

### MAXIMUM SQ\_two floor building

560 sq	24 people
720 sq	30 people
<b>TOT 1280 sq</b>	<b>54 people</b>

# Master Plan (High Density)



## Define Path



## Locate Open Space



## Apply typology



## Connect Open Spaces with the City

