

# 21<sup>st</sup> Century Housing Typologies

University Name: Beijing Institute Of Fashion Technology

Project Name: Kurt---Schumacher---Quartier Residence Design

Student Name: BAI TIANYU

Professor Name: CHE FEI , ZHANG XUEFENG

# Site Analysis



This is an analysis of traffic on the status quo

## Master Plan (if applicable)



# Project Ideas

This is the prototypology and the traffic analysis chart , respectively, clearly account of the traffic relationship here .

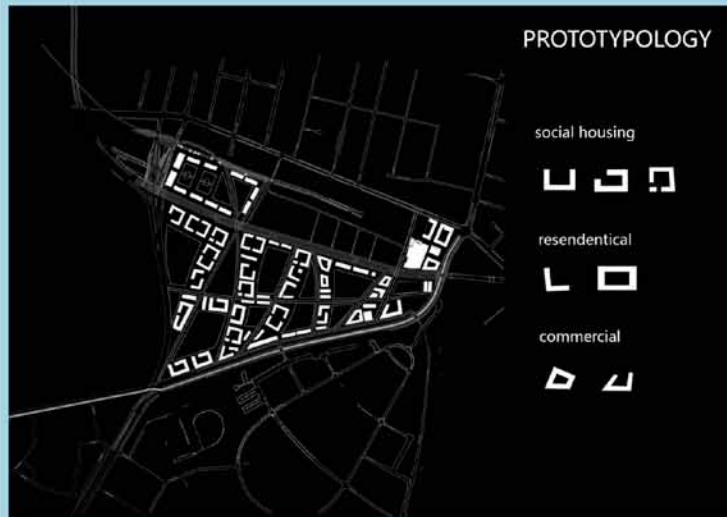

# Project Ideas

This is the 3D view



# 21<sup>st</sup> Century Housing Typologies

University Name: South China University of Technology

Project Name: Kurt---Schumacher---Quartier Residence Design

Student Name: Sijun Lin

Professor Name: Che Fei



# Site Analysis

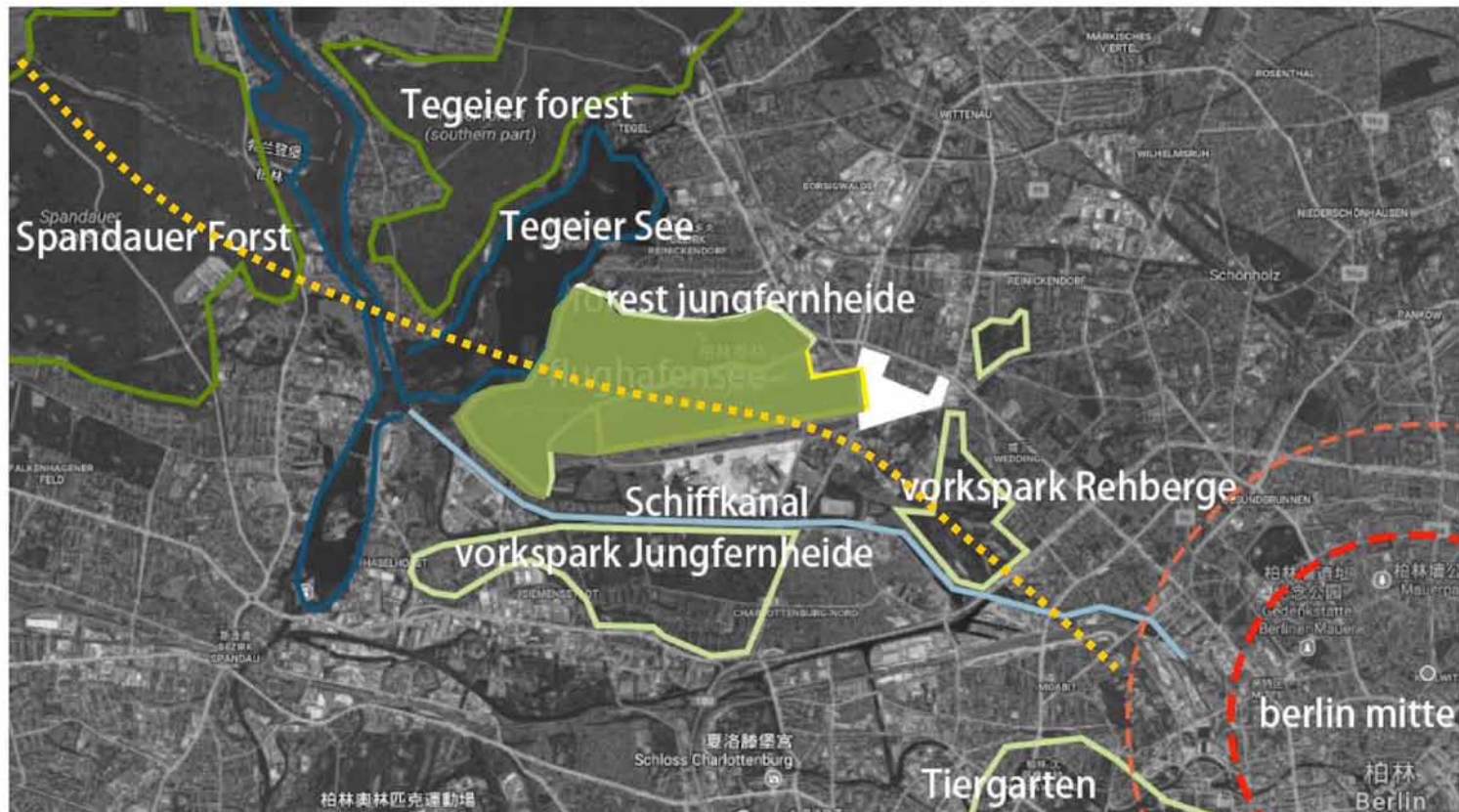

The site located in the place that connects the big green area in the west and the crowded city in the east. The green system changes itself from big green system such as forest to Volkspark which offers different kinds of activities. So it will make our city green system more complete if we let our city be a part of the city green system.

## Master Plan (if applicable)





# Project Ideas

The project try to solve three connection problems. The connection with two green system ,the connection with working spaces and the living spaces and the connection with the Tegel smart city to the current commercial center. Most of all, the project try to complete the city green system with a center park in the site. And this concept will still used in the form of the building.



# Project Ideas

The project try to do some research on the mix of different function of building. In the red zone, there is the mix of commercial and living function building. In the yellow zone there is the public building such as school ,kindergarten and library. And I want to create more roof space for plants to strengthen the city green system, and more then this ,let it be a public spaces for people who lives here.





# 21<sup>st</sup> Century Housing Typologies

University Name: Karlsruhe Institut für Technologie

Project Name: Kurt-Schumacher Quartier

Student Name: Yi Zhang

Professor Name: Fei Che , Xuefeng Zhang



# Site Analysis



Structure of the area

## Master Plan (if applicable)





# Project Ideas

In order to connect the new area and the commercial center, as well as to connect the military area and the existing old area, a huge bridge was designed. On the bridge is the sky garden, under the bridge is the flexible rooms for the people.



# Project Ideas

The bridge is a mega meeting point for the people.

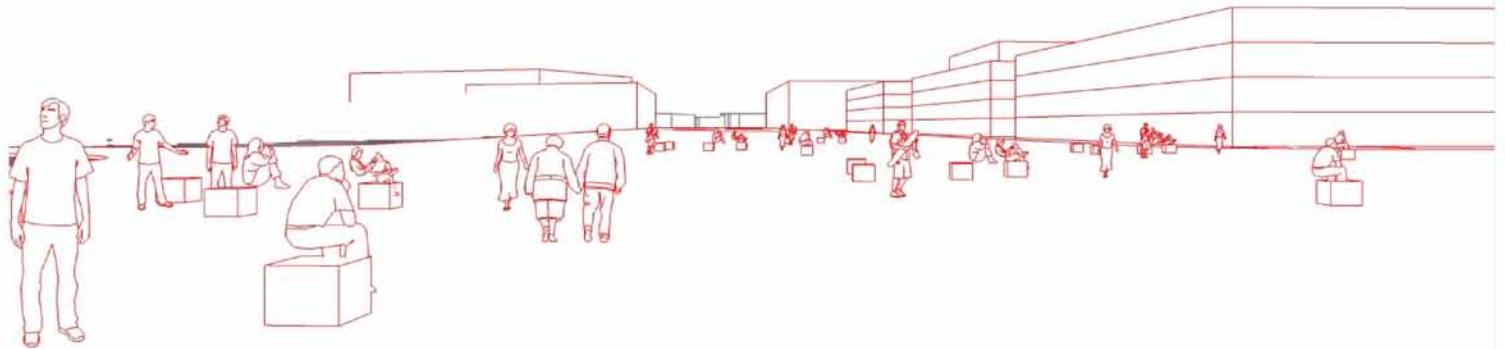





# 21<sup>st</sup> Century Housing Typologies

University Name: Beijing Institute of Fashion Technology

Project Name: Kurt-Schumacher-Quartier

Student Name: Yang Wenlei

Professor Name: Che Fei Zhang Xuefeng

# Site Analysis



Historical review

## Master Plan (if applicable)





# Project Ideas

There are five types in this plan, residential, social housing, school, commercial, mix. commercial district can attract people to come here, and increase the economic growing.



# Project Ideas



# Project Ideas



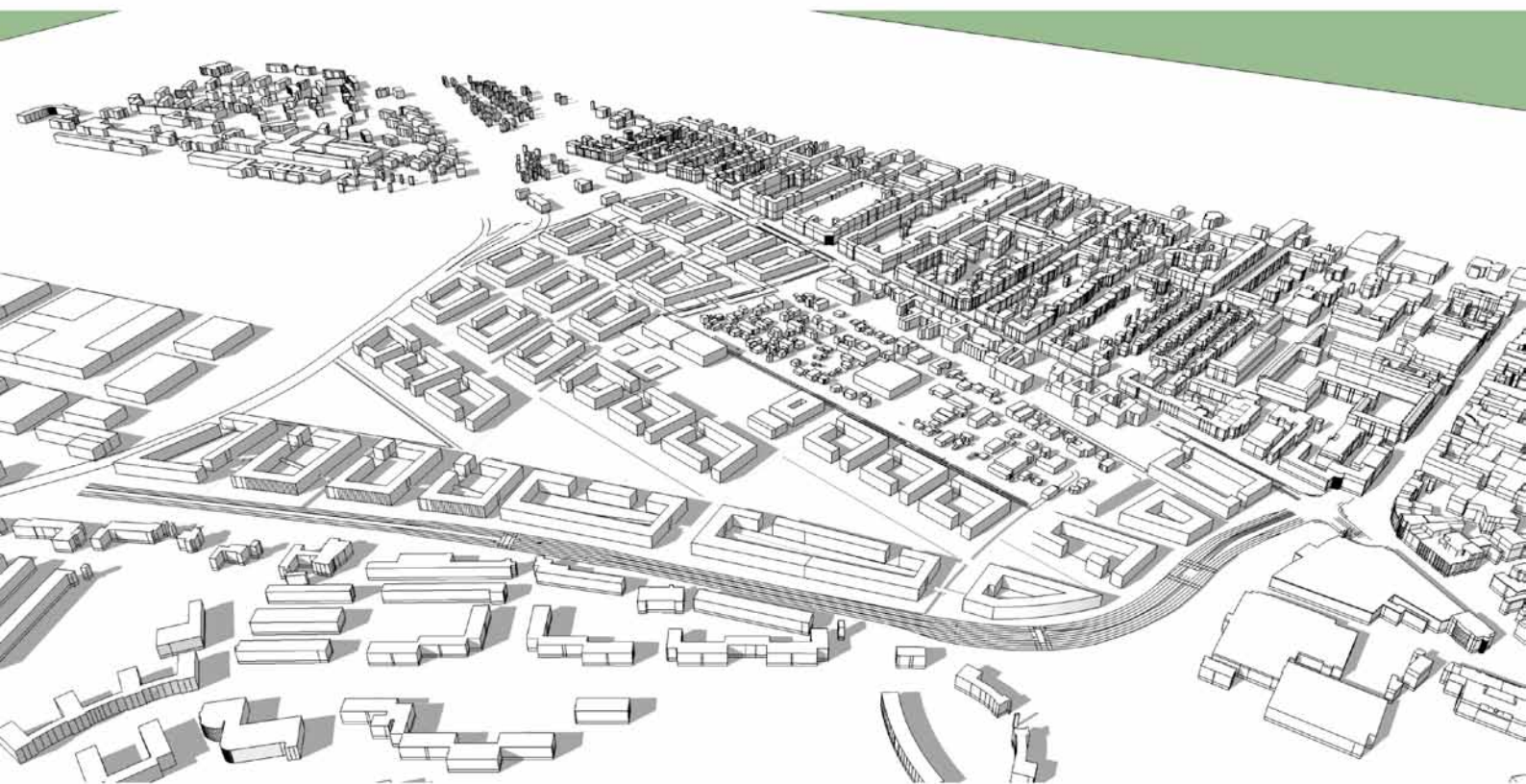



# 21<sup>st</sup> Century Housing Typologies

University Name: Beijing Institute of Fashion Technology

Project Name: Kurt-Schumacher-Quarter

Student Name: WANG Yu

Professor Name: CHE Fei

# Site Analysis

Room for images



Please enter description of site analysis

# Master Plan (if applicable)

Room for images

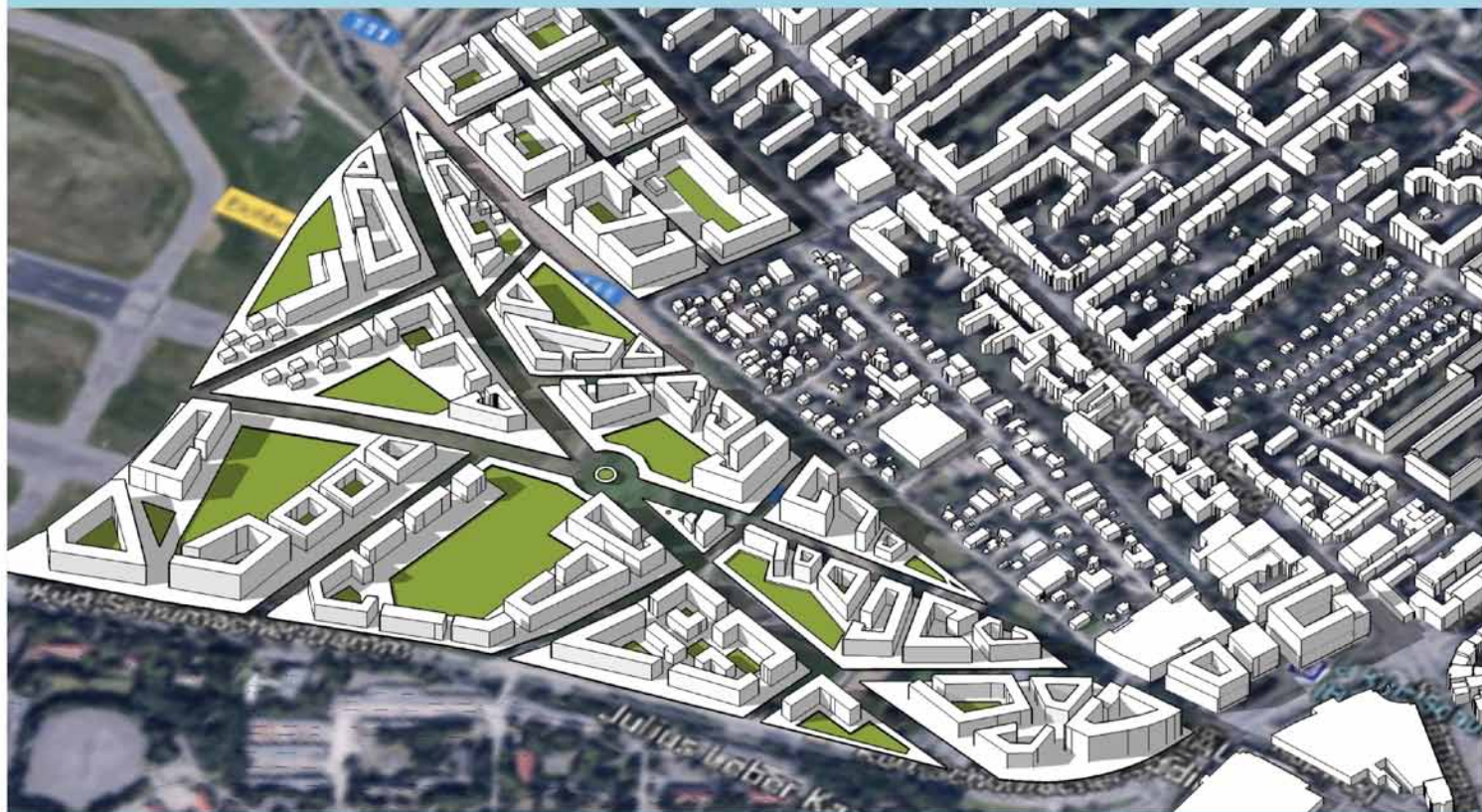

# Project Ideas



Function Division



# Project Ideas

Please enter project description (part 2)

within 10,000 people&5,000 unit of housing.

Space for elevations and renderings



# Project Ideas

Please enter project description (part 2)

Space for elevations and renderings

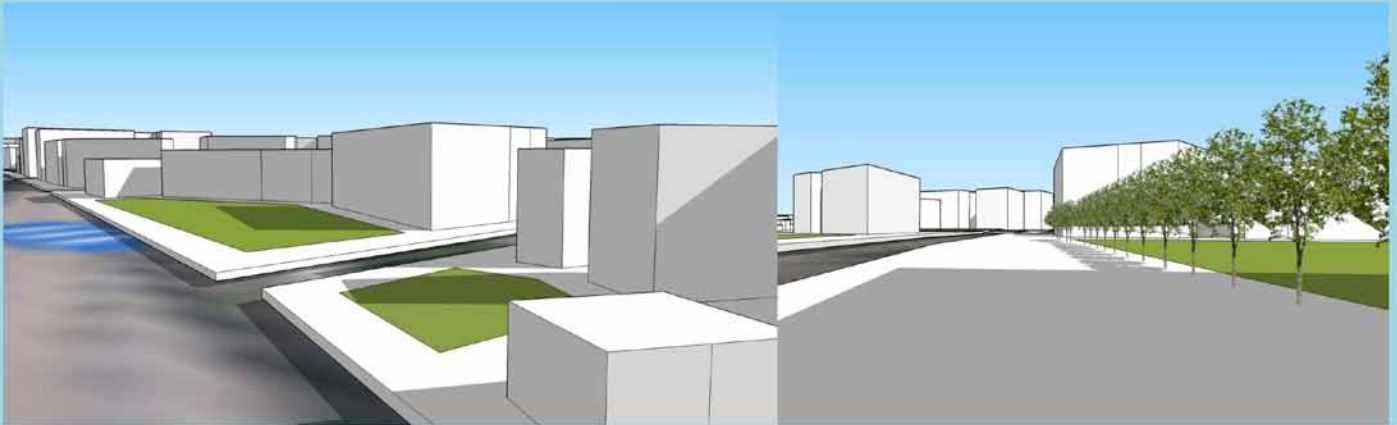

Room for more images and text

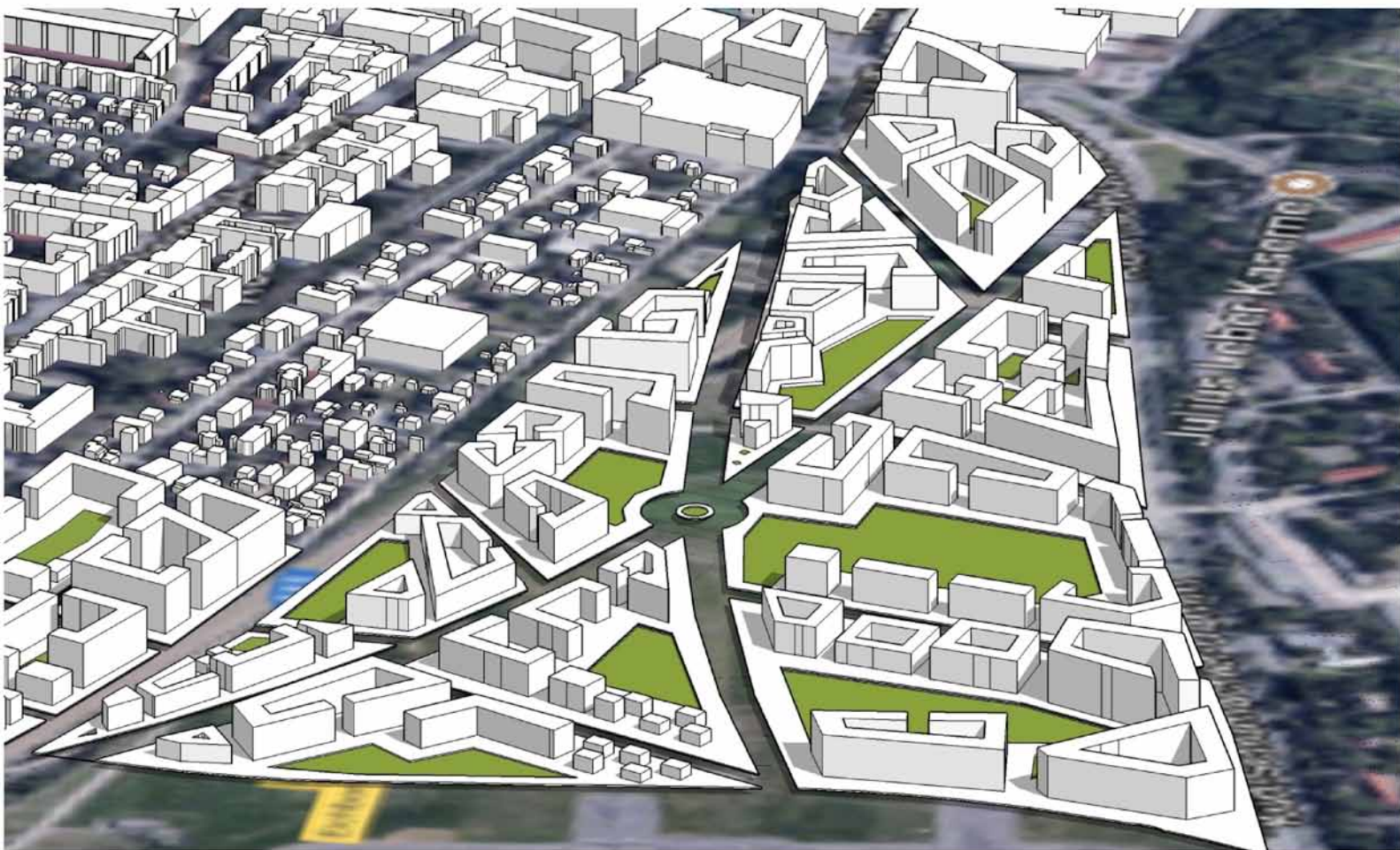

# 21<sup>st</sup> Century Housing Typologies

University Name: South China University of Technology

Project Name: Kurt-Schumacher Quartier Urban Design Studio

Student Name: Wu Yutong

Professor Name: Che Fei



# Site Analysis

## Site Visiting



The site was surrounded by TEGEL airport and self-growing village, which is unique to urban context.

# Site Analysis

co-housing project in Berlin



Block Scale

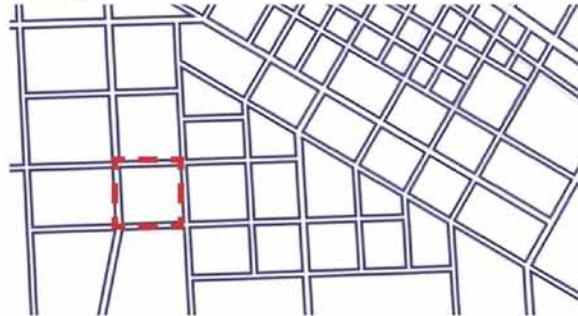

District Scale

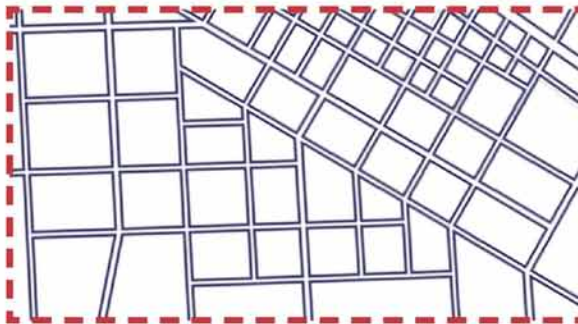

Berlin has old history in cohousing culture. Co-housing is an anti-masterplan and bottom-up approach to urban design. But most realized co-housing project is within a block or a single housing architecture. What if we bring this idea in to a whole district, and create a self growing community.

## Master Plan (if applicable)





# Master Plan (if applicable)

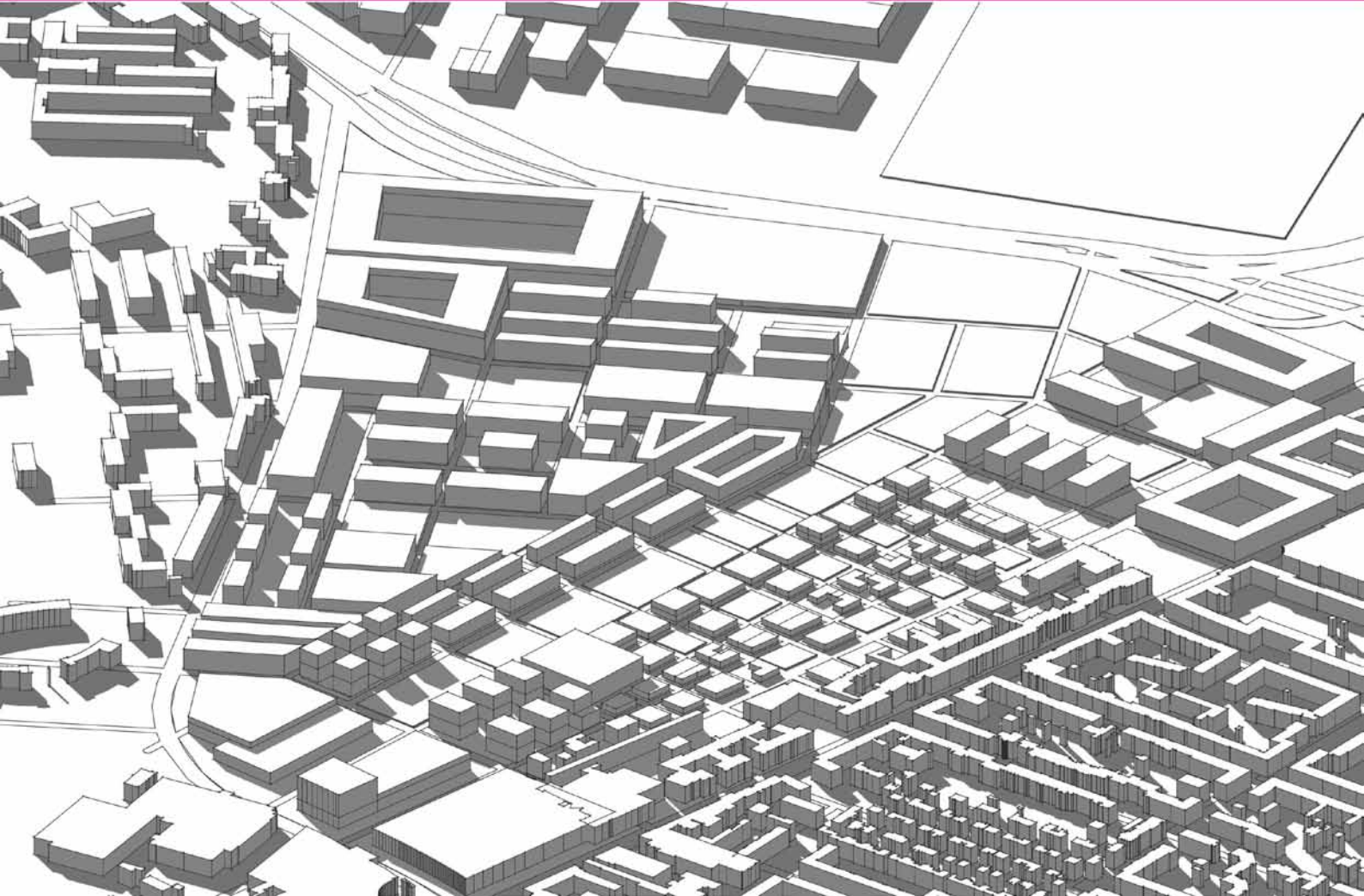



# Project Ideas

Project start with dividing the set into different size of district, giving possibility to different housing typology.



# Project Ideas

## Transportation



# Project Ideas

## Commercial Interface



# Project Ideas

Open Space





# Project Ideas

Land Usage



# Project Ideas

## Housing Typology

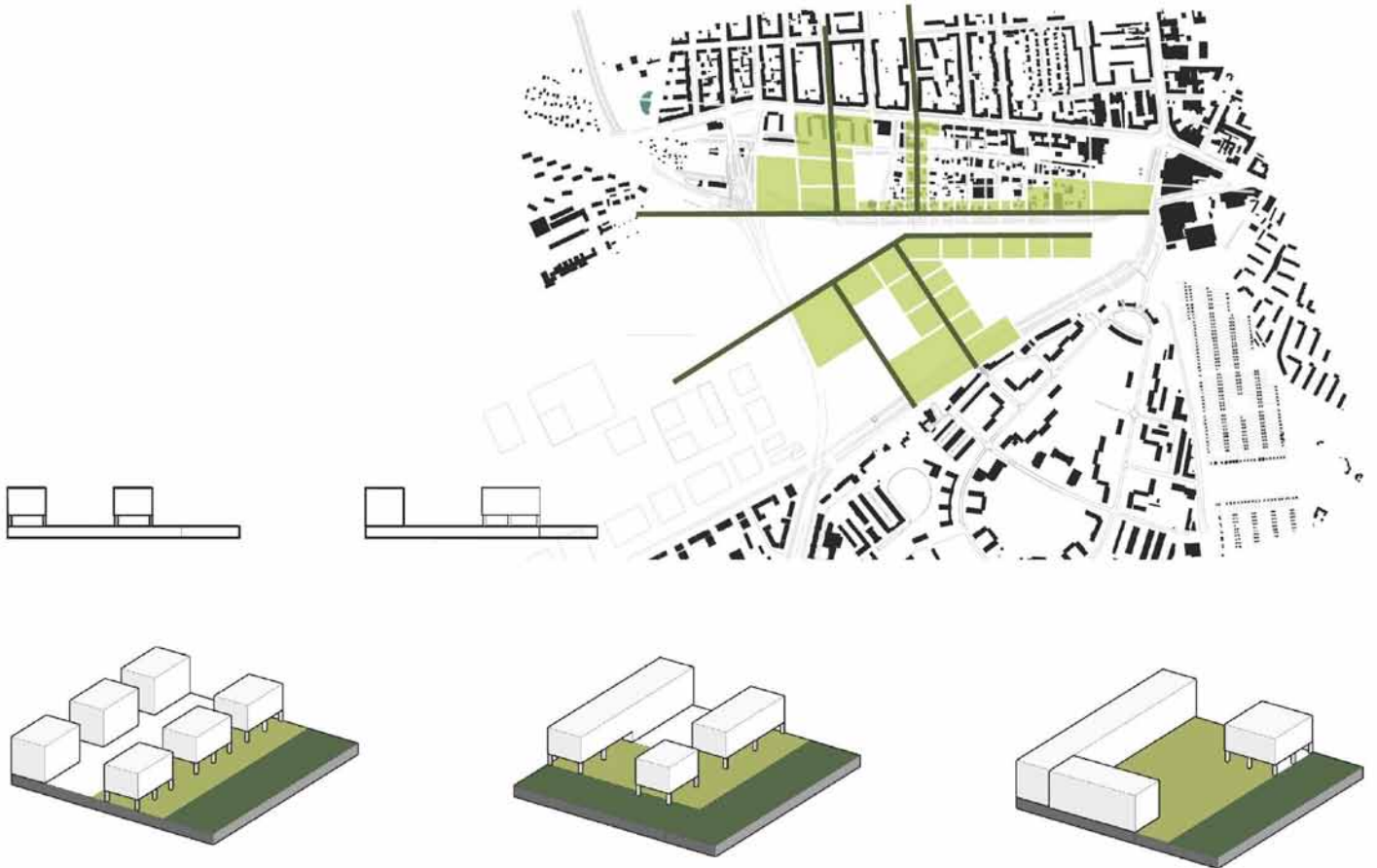

# Project Ideas

## Housing Typology

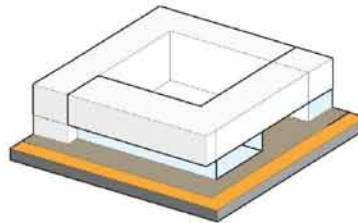
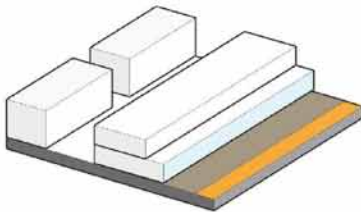
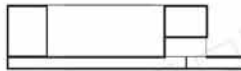
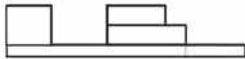

# Project Ideas

## User Typology



ARTIST



STUDENT





# Project Ideas

Context



# 21<sup>st</sup> Century Housing Typologies

University Name: Beijing institute Of Fashion Technology

Project Name: Kurt--schumacher--Quartier Residence Design

Student Name: Zhang Qi

Professor Name: Che Fei , Zhang Xuefeng

# Site Analysis



This is analysis of service and retail.

## Master Plan (if applicable)





# Project Ideas

This is the traffic and the prototypology analysis chart, respectively, clearly account of the traffic relationship here.



# Project Ideas

This is Axis mapping.

