

Kulturband

KULTURBAND

Projects Memory

We understand the Kulturforum as a piece inserted in the city, a piece without a relation with its context.

This peripheral condition, although being in the center of the city, is characterized for being an isolated and external piece. In the other hand, the buildings that make this forum are understood as separated pieces, without having a relation in between them.

Even with this characteristics, the space has a big amount of empty places, which gives us a great potential to exploit the soil.

Given this problematic, we propose a union system that offers a different look to the buildings, looking to find a union between the Tiergarten and Landwehrkanal, generating this way an introduction of this "urban piece" to his environment.

It's important to understand that we create the connection from an elevated band, understood as a continuation of the trail that comes from the Tiergarten, for understanding buildings specially and in its total volumetric quality, which is hard, almost impossible from a person's street view. With the gained altitude it gives us the visual relation between the adjacent parks, inexistent without the band.

Associated with this connecting band we propose the extension of the New National Gallery, which has a direct connection with the band, permuting the use of this space to give life to the public areas. This, achieved with an annexed commerce plan (with direct relation to the culture) and truistic services. The new program rescues the multicultural environment, giving it value with gastronomies from different cultures around the world.

The language of the new museum responds to the presence of big stone blocks which are currently in the central park whom we want to rescue as references.

KULTURBAND Analysis



Kulturforum no genera conectividad entre los dos parques

No existe relación con el canal Landwehrkanal

Kulturforum entendida como pieza sin relación con su entorno

KULTURBAND

Analysis

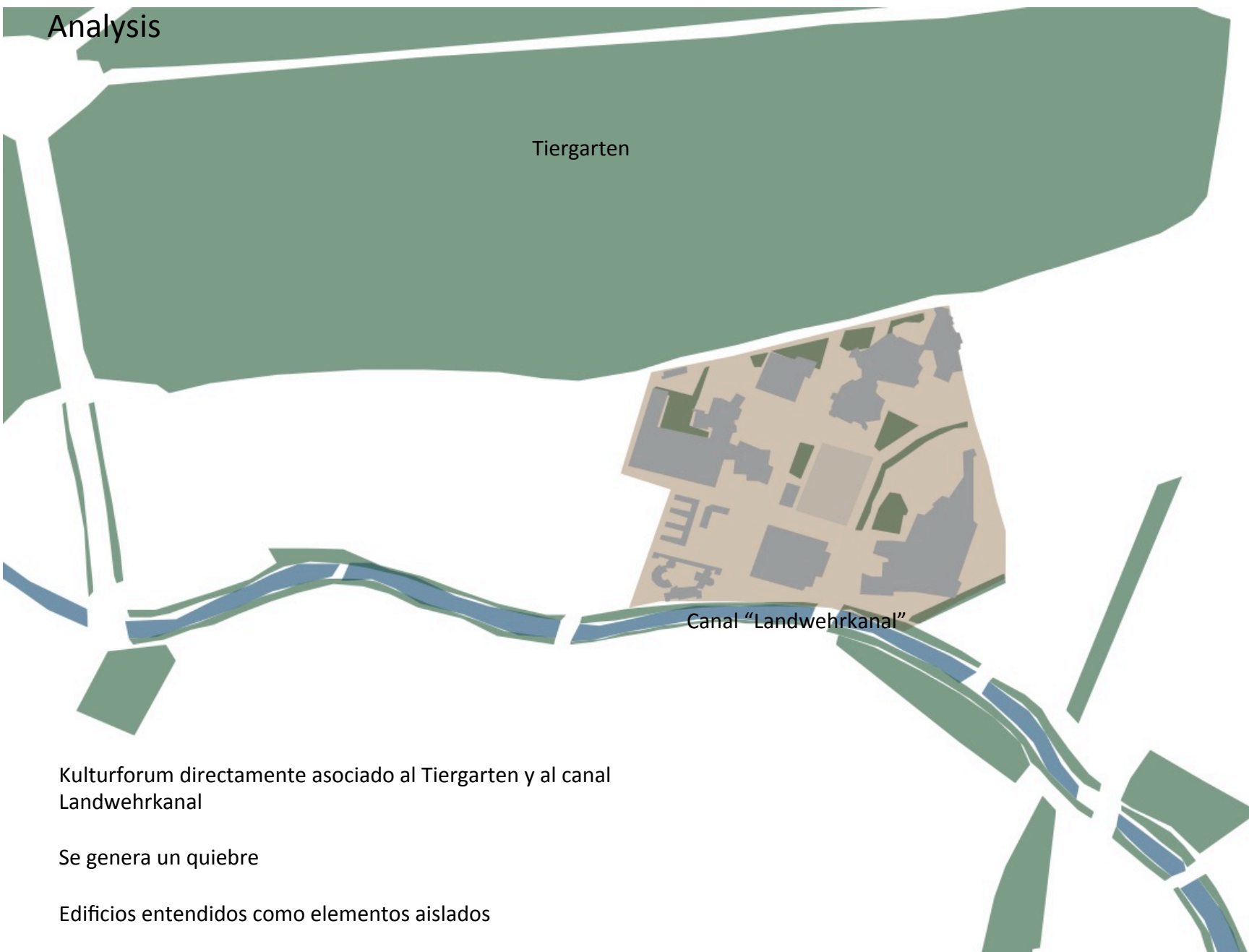

Tiergarten

Canal "Landwehrkanal"

Kulturforum directamente asociado al Tiergarten y al canal Landwehrkanal

Se genera un quiebre

Edificios entendidos como elementos aislados

KULTURBAND Analysis

Análisis alturas

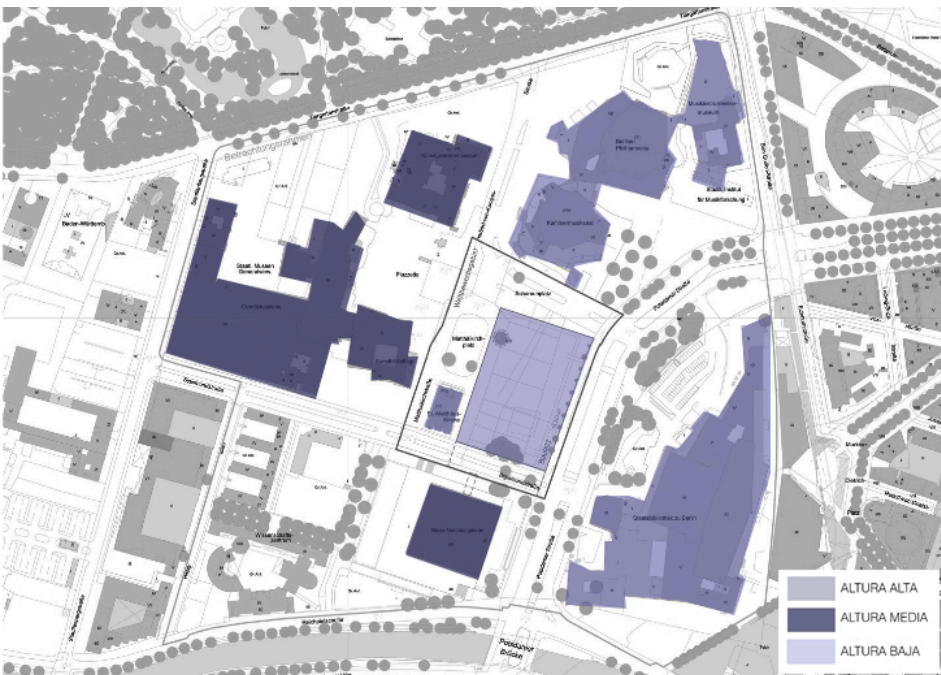

Altura media 10-15 metros
Altura alta 30-45 metros

Análisis flujo vial

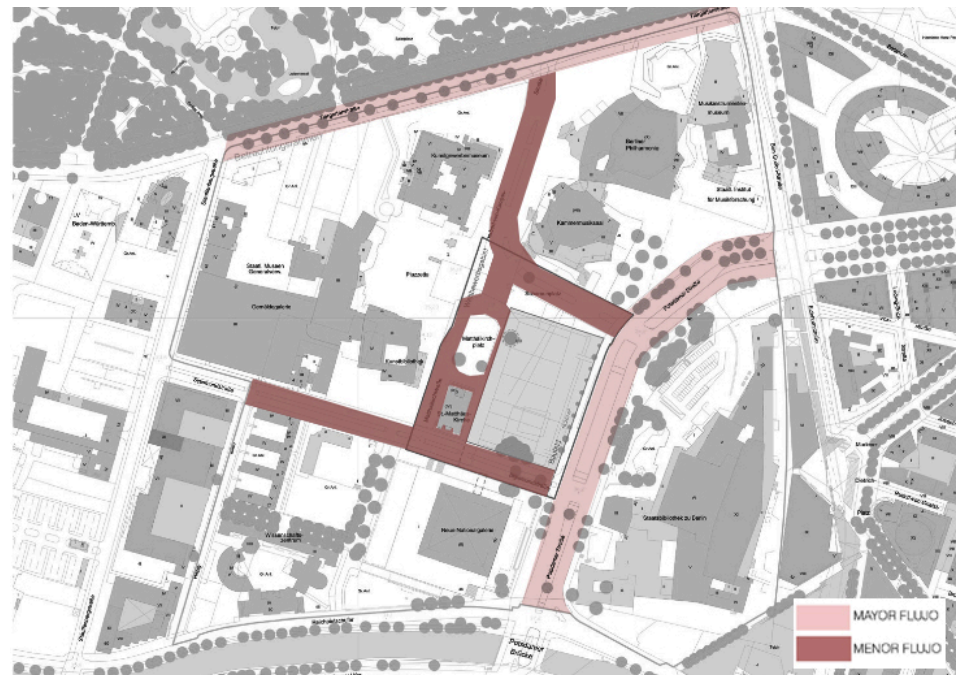

KULTURBAND

Analysis

“Architecture and urban design, both in their formal and spatial aspects, are seen as fundamentally configurational in that the way the parts are put together to form the whole is more important than any of the parts taken in isolation.”

Bill Hillier

KULTURBAND Project

Cinta nace en el
único punto en que
sendero del parque
tiene continuidad
con calle de KF

Cinta que busca crear
una unión continua/ no
forzada

Plaza central

Buscar relación entre
parques
(Tiergarten y Borde de
Spree)

Crear continuación del
sendero del parque

Canal "Landwehrkanal"



KULTURBAND Project

Tiergarten

Permite la observación de los edificios desde una perspectiva más alta (comprensión espacial y volumétrica).

KF de los museos

Plaza central

Iglesia

Nueva galería nacional

Biblioteca

Canal "Landwehrkanal"

KULTURBAND Project

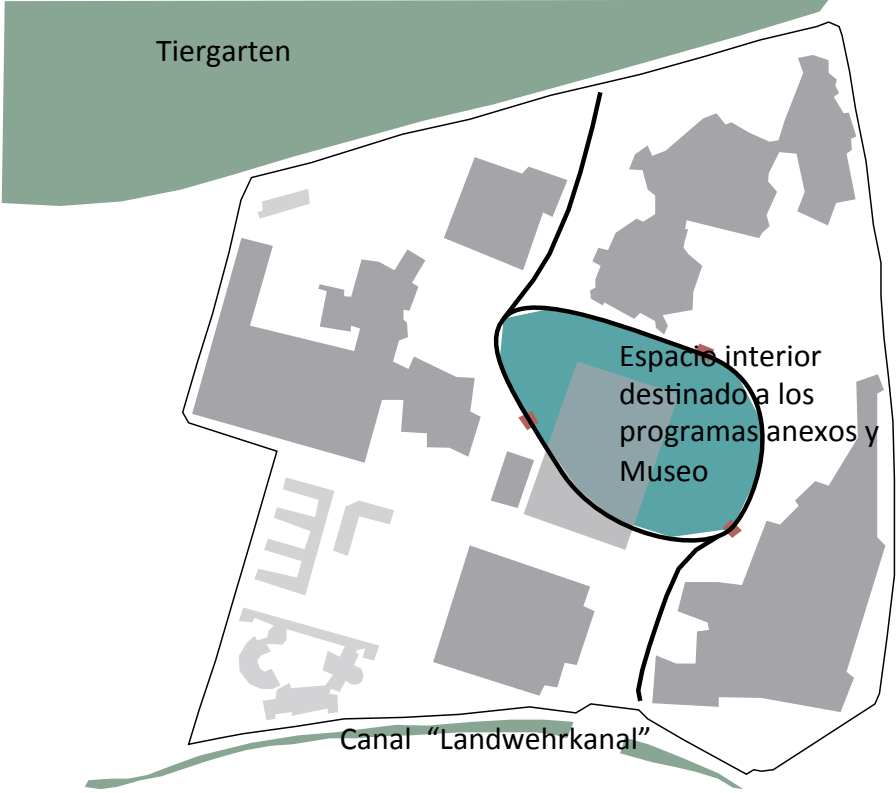

Nuevo museo toma altura de cinta, y se entierra en el terreno

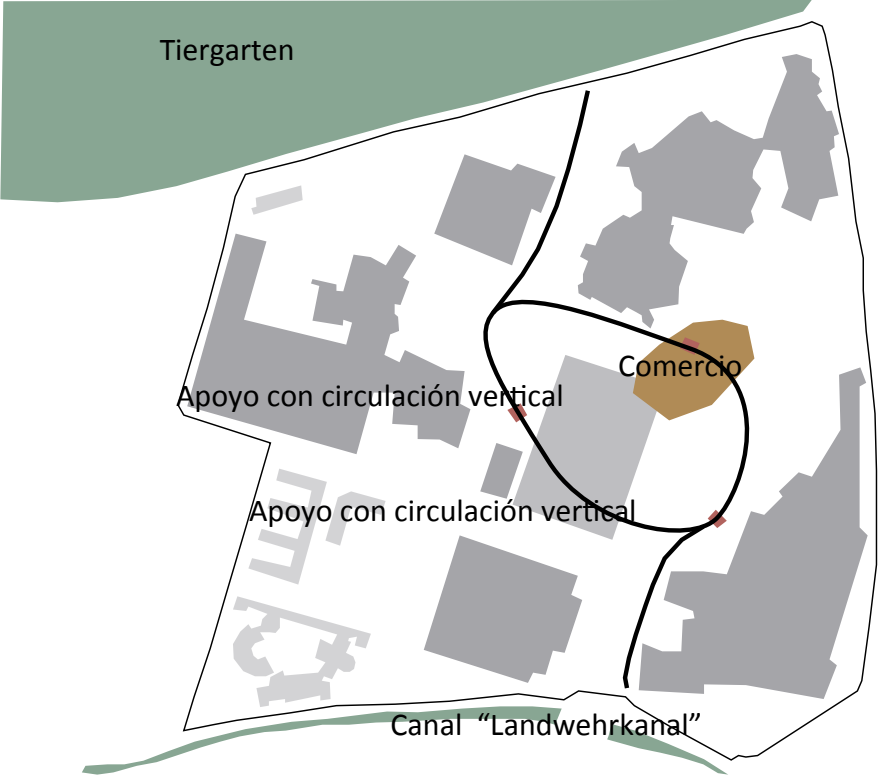

Programa anexo, Comercio

Comercio en cubierta de Nuevo museo

KULTURBAND Project



Pasarela de 12 metros de altura, 4,5 de ancho y 3 metros de alto

Trabajo de pavimento que busca generar continuidad y unidad en el Kulturforum

Eliminación de calles y nivelación de suelo

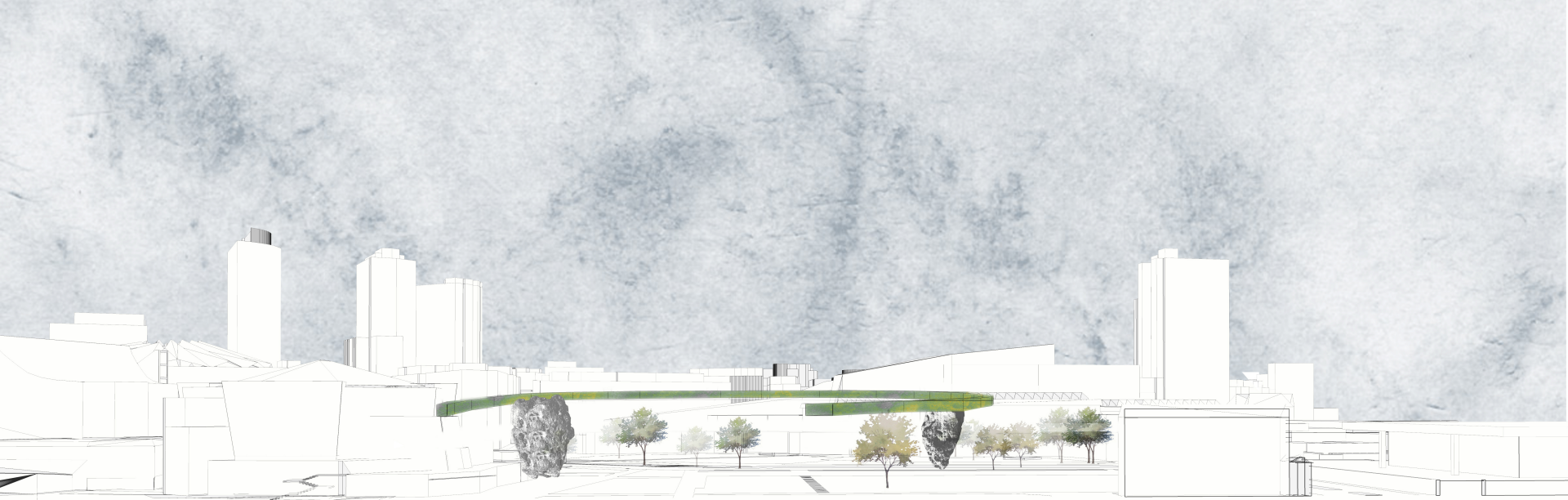

Filarmónica

Biblioteca

Nueva galería
Nacional

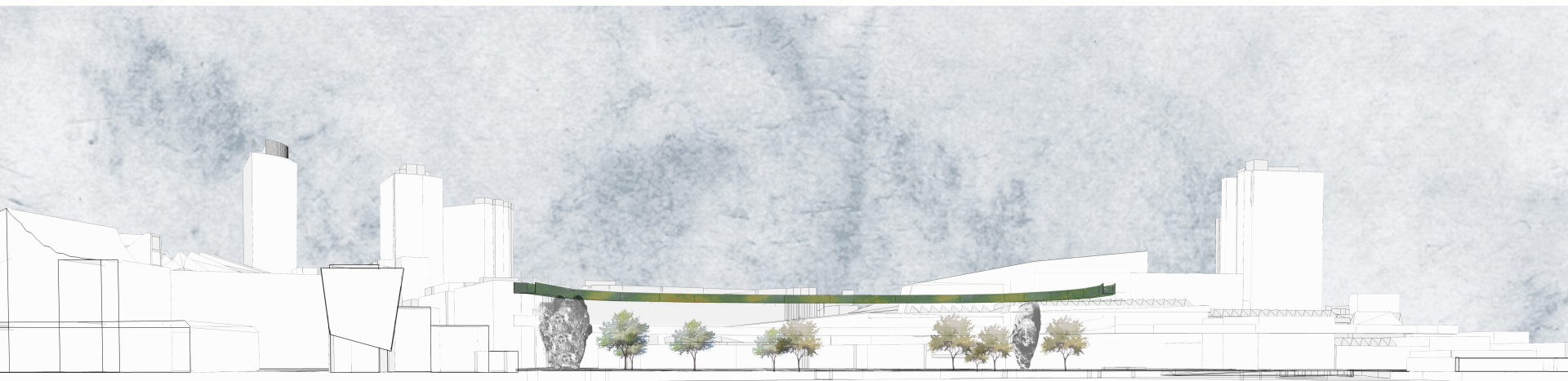

Filarmónica

Biblioteca

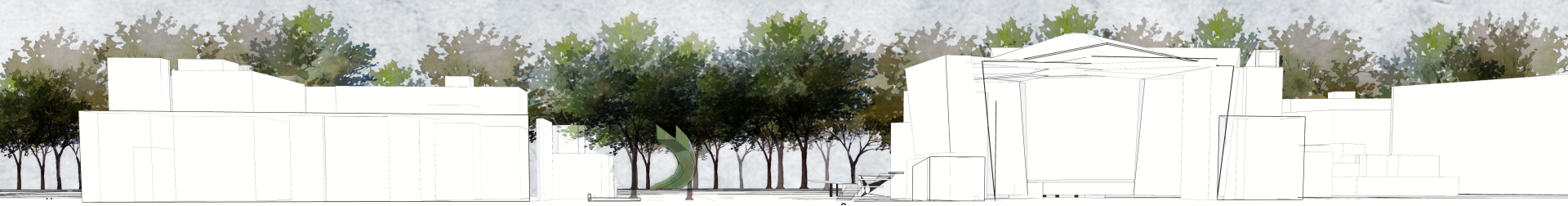

KF Gemäldegalerie

Tiergarten

Filarmónica

KULTURBAND Project

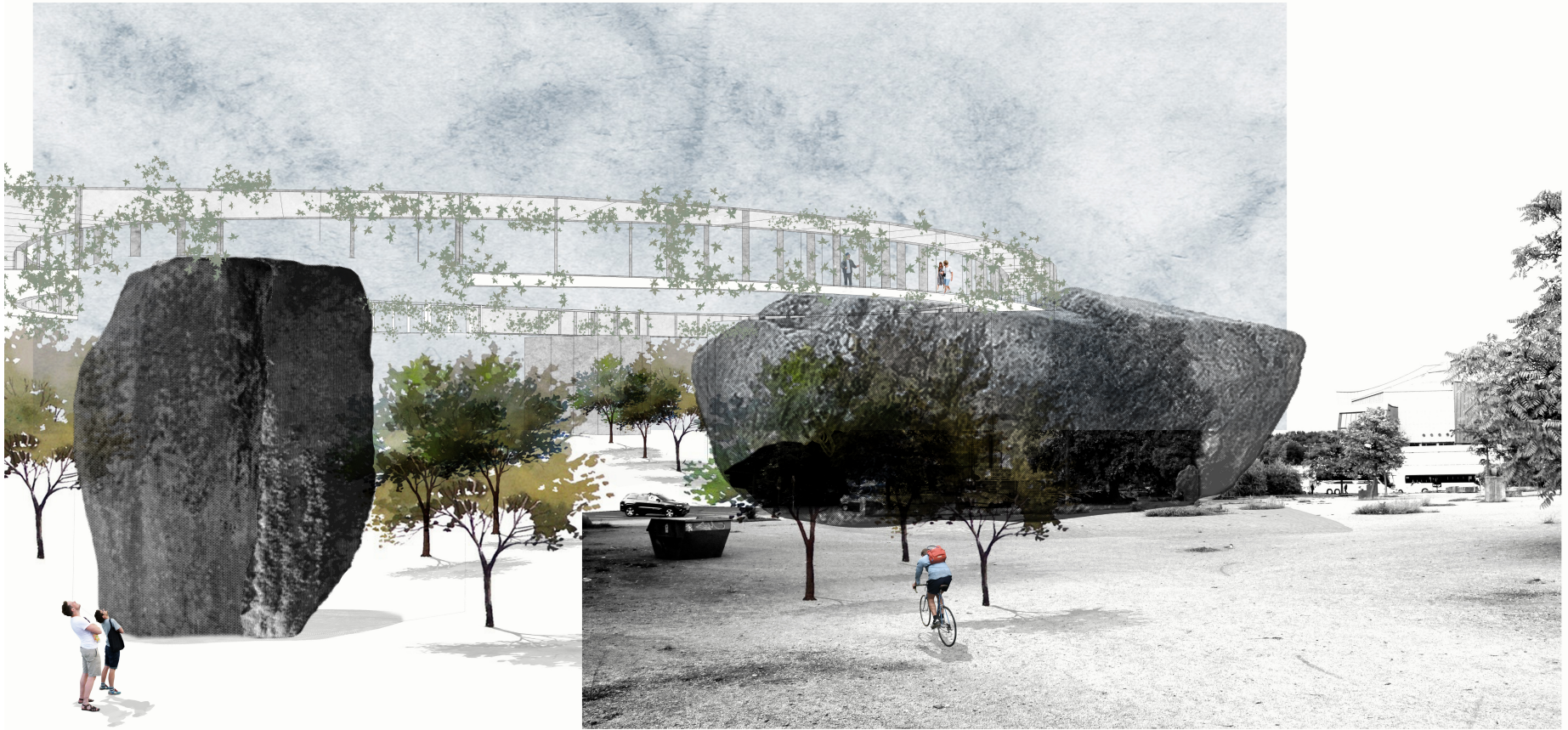

KULTURBAND Project



KULTURBAND Project



KULTURBAND Project

