

KULTURFORUM HUB



Entrance Perspective

The design proposal is a fusion of architecture and landscape to bind the disparate precincts of the kulturforum together and form a cohesive whole. It is a place of gathering housing multiple programs for the users. Mainly, an information centre responding to the recurrent problem of wayfinding on site. It also comprises of exhibition spaces informing the visitors about the rich history of the kulturforum often overlooked. Moreover,

various seasonal activities such as a Sunday Market can be held in the courtyard. This will encourage the broader community to enjoy the space and interact with the kulturforum and one another. The landscape is shaped to converge the main access points from the precincts towards the hub located at the core of the kulturforum. The landscape unfolds to offer visitors suffering from media overload and exhibition fatigue a place to rest.

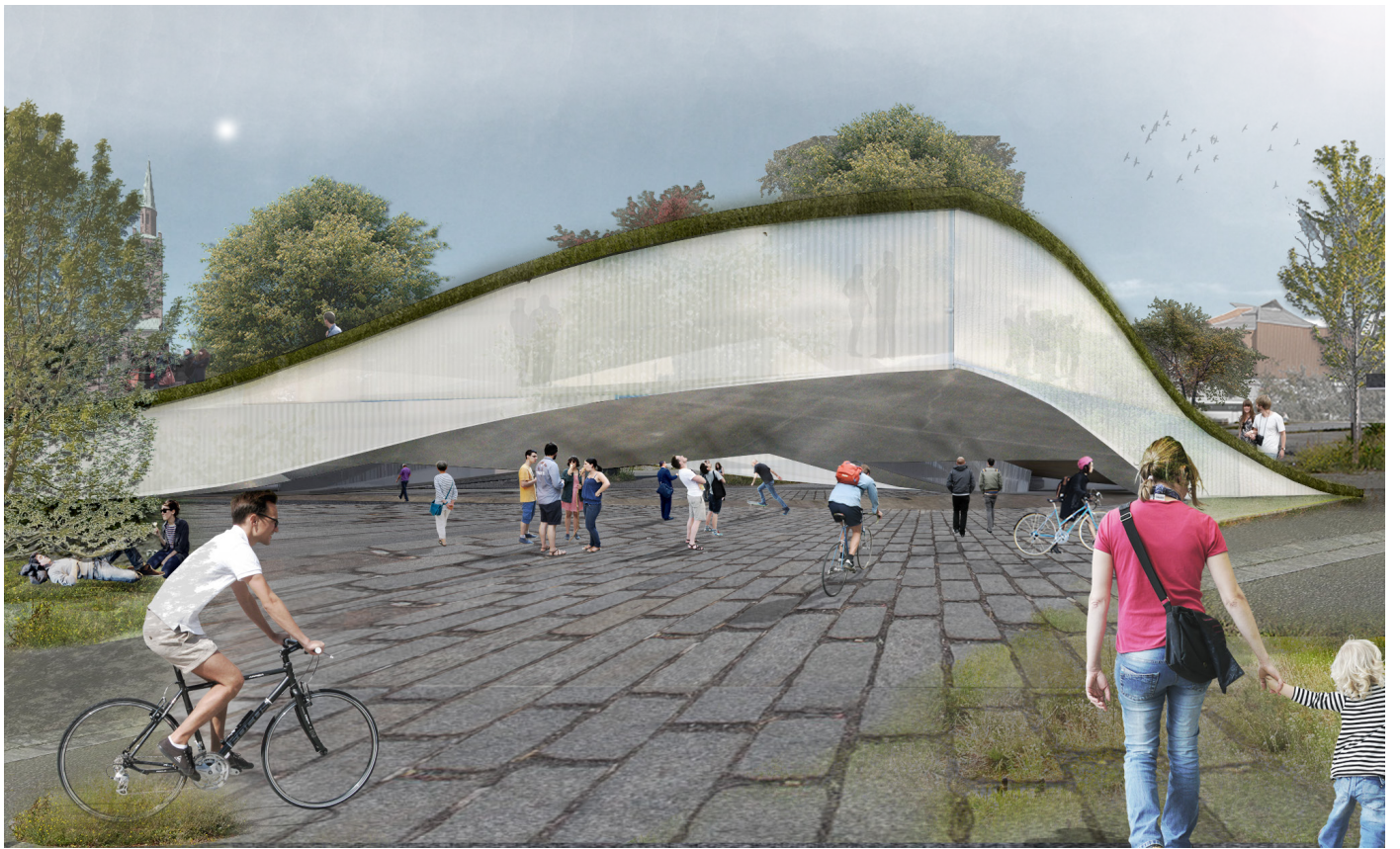

Entrance Perspective



Sunday Market in Courtyard











Masterplan

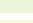
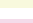

SITE ANALYSIS





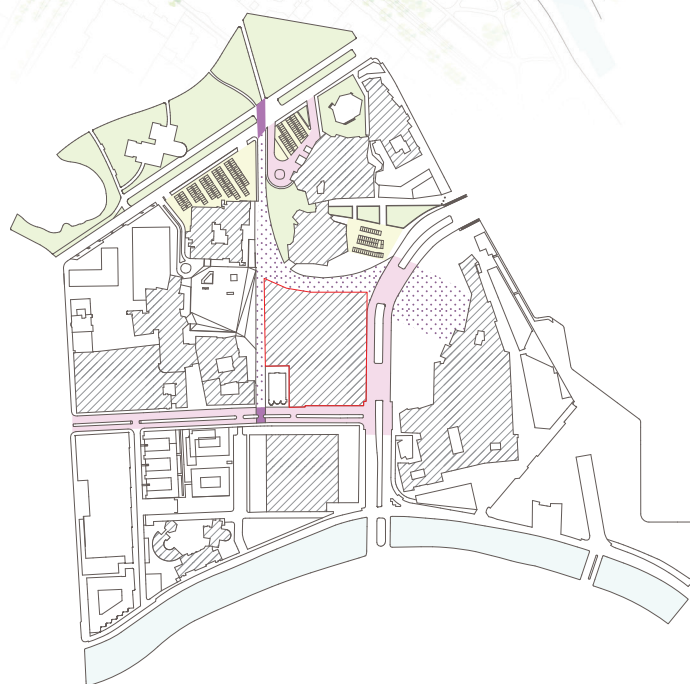

KEY

-  PROPOSED SITE
-  CANAL
-  TIERGARTEN
-  PARKING/SERVICE
-  ROADS
-  PEDESTRIAN CROSSING
-  PEDESTRIAN CIRCULATION
-  MAIN ACCESS
-  PROBLEMATIC AREAS



URBAN STRATEGIES

KEY

-  PROPOSED SITE
-  CANAL
-  TIERGARTEN
-  PROPOSED PARKING
-  PEDESTRIAN CROSSING
-  PEDESTRIAN WALKWAY
-  ROAD MATERIALITY CHANGE

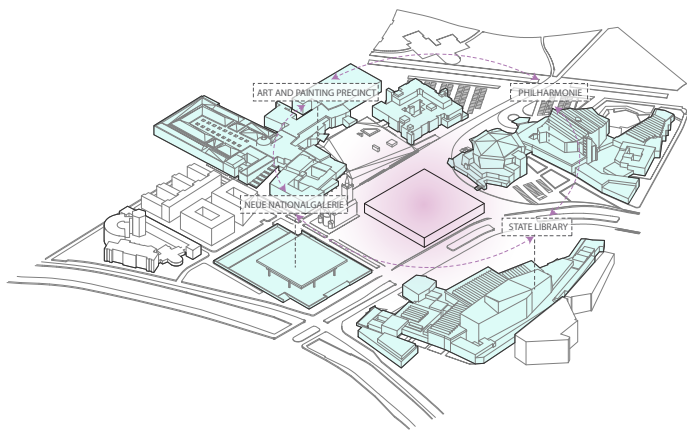

Intervention

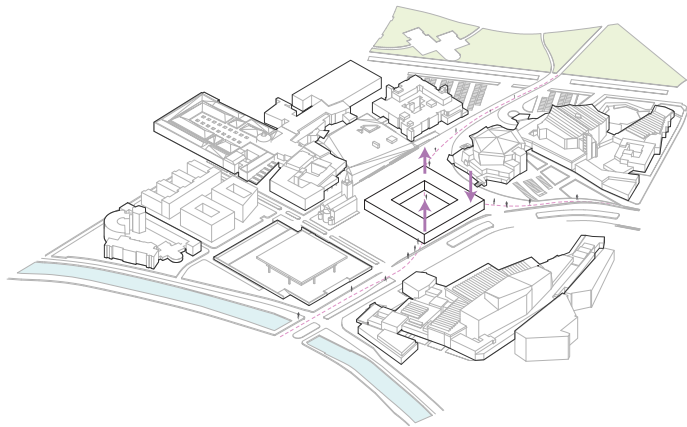

Form Finding

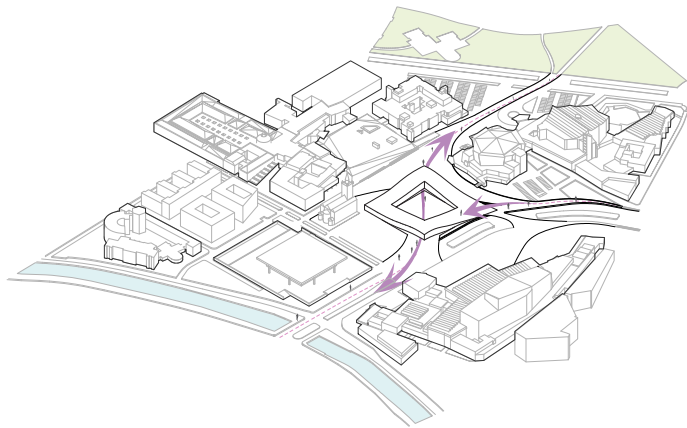

Access

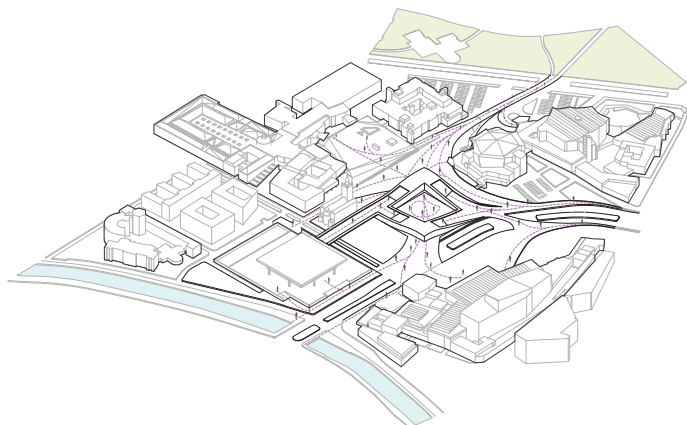

Circulation

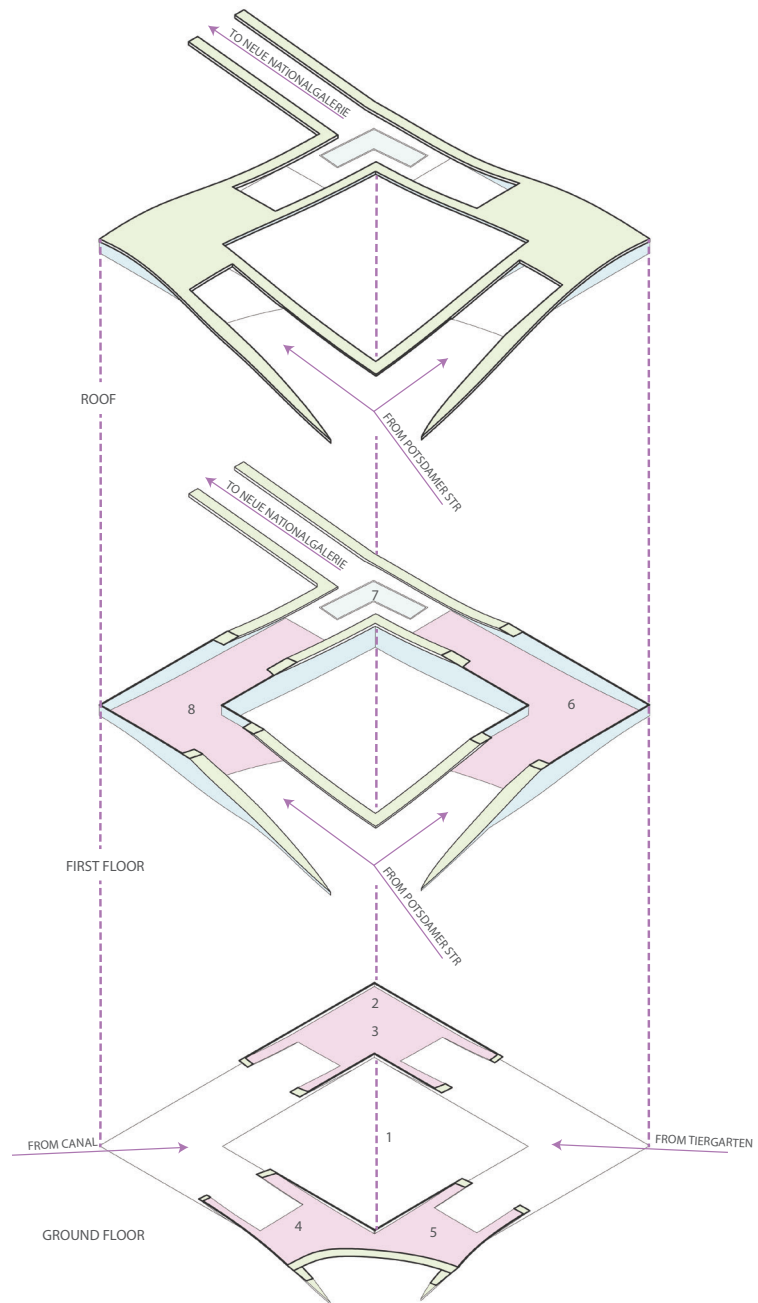

Isometric diagram

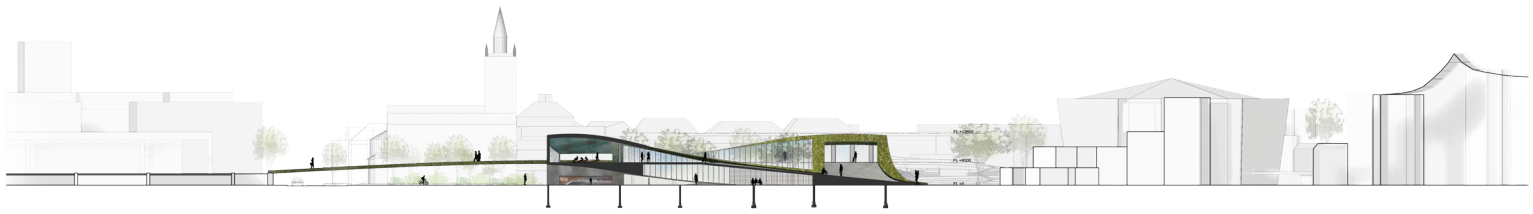

Section X-X'



Ground Floor Plan

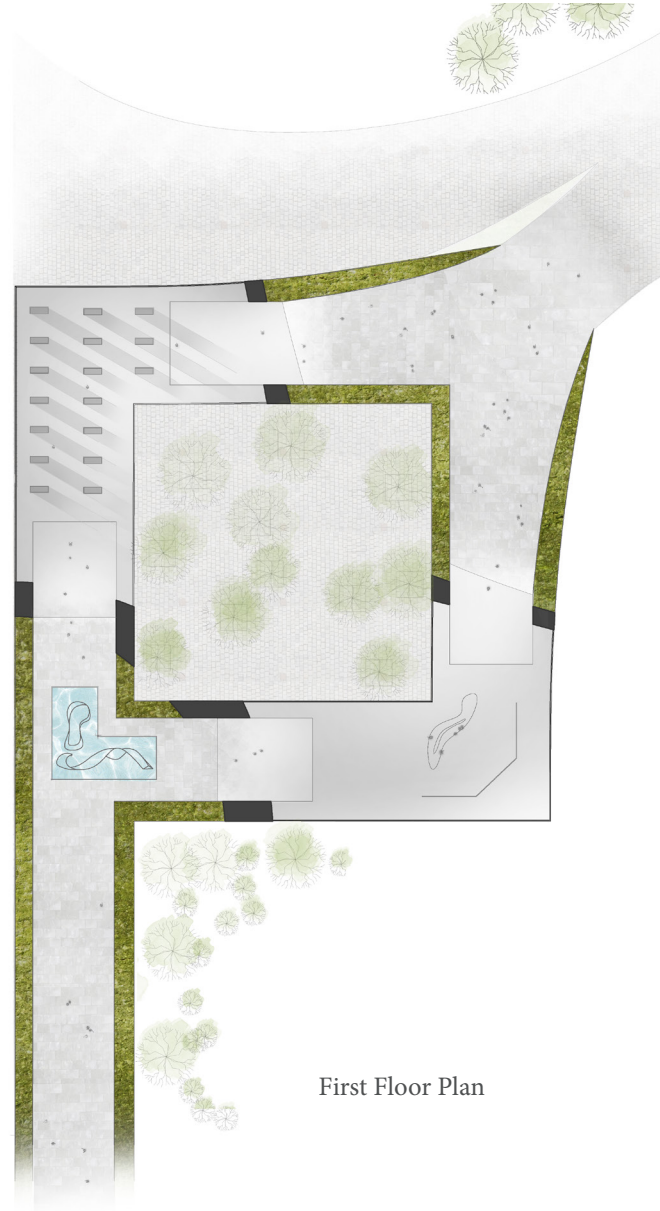

First Floor Plan

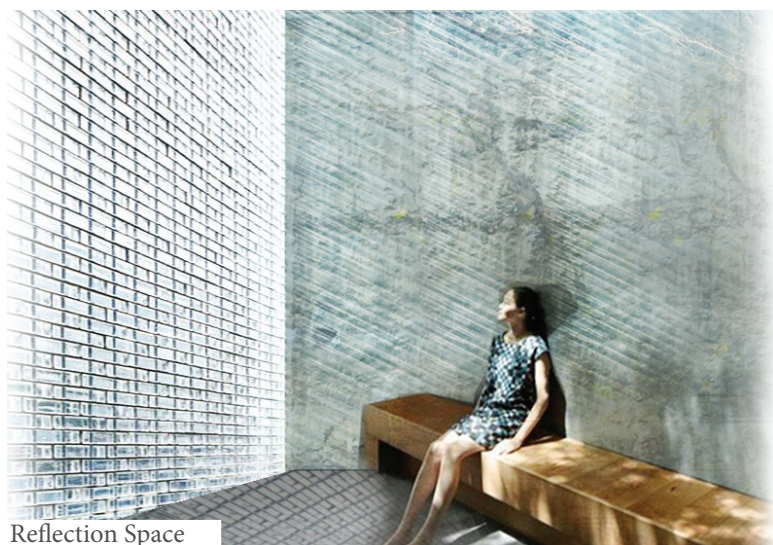

Reflection Space



Exhibition Space